

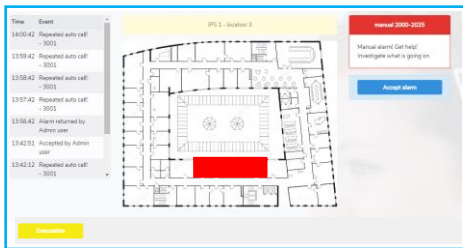

Introduction Announcement Communication Server

Intro_DP_Server_En_21.05



Date: 29th of January 2021
Product: Communication Server
Product release date: 31st of March 2021

Product description

Basically the Communication Server consists out of a server PC with application software and a PD6000-IP Interface to connect the server PC with the DP6000 system.

The Communication Server and DP6000-IP interface replaces the former Alpha-desk and Atus Commander and is therefore a full compatible successor. Several new functionalities, a graphical user interface and new application possibilities are implemented to meet the today's functional demands and high reliability standards.

Thanks to the new designed system architecture it is made easier to create system redundancy and if desired, the application software is available as image in case the application software should run in a virtual environment.

Keywords and options:

- ▶ Linux based application software
- ▶ Flexible system architecture
- ▶ Guarded system infrastructure
- ▶ Integral system redundancy

- ▶ Manned and unmanned work mode
- ▶ Designed to handle critical messaging and Personal Security applications
- ▶ Suitable for Dutch NEN2575 applications (evacuation system)
- ▶ Detailed logging and reporting facilities
- ▶ Different authorisations to log on to secure system performance.

- ▶ ESPA 4.4.4 coupling
- ▶ I/O contact coupling with voltage free input and output contacts
- ▶ RS485 coupling, therefore compatible with the LBB5843/01 Multiple Purpose Coupler

- ▶ Dedicated Server PC or Virtualisation possible
- ▶ Designed to integrate multiple DP6000 sites with one server
- ▶ Web based, simultaneous, access for multiple operators
- ▶ Remote Maintenance through protected Web based access

Powered by:
Next Generation
Technology





1 Commercial items

Several options are made available to offer a best possible solution for each customers' requirements. The overviews below shows all options of hardware, software and licences. For availability and up to date pricing, refer to our website.

1.1 Available Items

The items listed below, can be ordered separate to create a free to be defined system or to expand existing systems, which contains already a Communication Server, with additional options.

| Description Hardware | 12NC | Type nr | Gross Price/each (BLP) 2021 |
|---------------------------------|----------------|-------------|-----------------------------|
| Communication Server PC | 8900 800 00001 | LBB 8000/00 | € 3.250,00 |
| DP6000-IP Interface | 8900 800 10001 | LBB 8001/00 | € 1.750,00 |
| Input Contact Module | 8900 590 10001 | LBB 5901/00 | € 755,38 |
| Output Contact Module | 8900 590 20001 | LBB 5902/00 | € 629,84 |
| ESPA 4.4.4. Interface Module | 8900 590 30001 | LBB 5903/00 | € 540,16 |
| RS485 Interface Module | 8900 590 40001 | LBB 5904/00 | € 890,00 |
| Cable set (set of 2) | 8900 800 30001 | LBB 8003/00 | € 115,00 |
| | | | |
| Description Licenses | 12NC | Type nr | Gross Price/each (BLP) 2021 |
| Image Basic Software Package | 8900 800 00101 | LBB 8000/01 | € 1493,00 |
| Activation Logging | 8900 860 00001 | LBB 8600/00 | € 613,00 |
| Activation Personal Security | 8900 860 10001 | LBB 8601/00 | € 1375,00 |
| Activation Multi Users | 8900 860 20001 | LBB 8602/00 | € 1375,00 |
| Activation Multi Site | 8900 860 30001 | LBB 8603/00 | € 1375,00 |
| Activation 3rd Party Connection | 8900 860 80001 | LBB 8608/00 | € 1375,00 |

1.2 Basic Messaging Server

The 'Basic Messaging Server' is offered as a complete set, against a fixed Nett Price.

The content is defined such that the Basic Messaging Server covers the function for critical messaging; f.i.: out of range indication, absent detection, call forwarding, making group calls, low battery indication, fast buttons etc. etc.

In the data sheet a functional description of the Basic Messaging Paging server can be found. Below all hardware, software and licences that are included in this product is listed.

| Amount | Description | 12NC | Type nr | Nett Price 2021 |
|--------|------------------------|----------------|-------------|-----------------|
| 1 | Basic Messaging Server | 8900 800 01001 | LBB 8000/10 | € 3.870,00 |

Content of a Basic Messaging server:

| Amount | Description | 12NC | Type nr | Remark |
|--------|------------------------------|----------------|-------------|-----------------------------------|
| 1 | Communication Server PC | 8900 800 00001 | LBB 8000/00 | 1 per system |
| 1 | DP6000-IP Interface | 8900 800 10001 | LBB 8001/00 | 1 per (sub) system |
| 1 | ESPA 4.4.4. Interface Module | 8900 590 30001 | LBB 5903/00 | Port 3 can be set as output port |
| 1 | Input Contact Module | 8900 590 10001 | LBB 5901/00 | 4 contacts at 1 module |
| 1 | Cable set (set of 2) | 8900 800 30001 | LBB 8003/00 | Needed to guard 2 contacts |
| 1 | Image Basic Software Package | 8900 800 00101 | LBB 8000/01 | Installed at the server PC |
| 1 | Activation Logging | 8900 860 00001 | LBB 8600/00 | To activate registration of calls |

- Notes:**
- Other relevant licences needed for a Basic Messaging Server are already included
 - Refer to "Available Items" for relevant Gross Prices. (BLP), if the Basic Message Server needs extra additions.





1.3 Basic Personal Security Server

The 'Basic Personal Security Server' is offered as a complete set against a fixed Nett Price.

The content is defined such that the Basic Personal Security covers next to the functions described in the Basic Message Server, also covers Personal Security functions like System monitoring, Personal Security alarms from mobiles, location detection, guard-tour and logging of alarm handling. In the data sheet a functional description of the Basic Personal Security Server can be found. Below all hardware, software and licences that are included in this product is listed.

| Amount | Description | 12NC | Type nr | Nett Price/each 2021 |
|--------|--------------------------------|----------------|-------------|----------------------|
| 1 | Basic Personal Security Server | 8900 800 02001 | LBB 8000/20 | € 5.935,00 |

Content Basic Personal Security Server:

| Amount | Description | 12NC | Type nr | Remark |
|--------|------------------------------|----------------|-------------|--|
| 1 | Communication Server PC | 8900 800 00001 | LBB 8000/00 | 1 per system |
| 1 | DP6000-IP Interface | 8900 800 10001 | LBB 8001/00 | 1 per (sub) system |
| 1 | ESPA 4.4.4. Interface Module | 8900 590 30001 | LBB 5903/00 | Port 3 can be set as output port |
| 1 | Input Contact Module | 8900 590 10001 | LBB 5901/00 | 4 contacts at 1 module |
| 1 | Cable set (set of 2) | 8900 800 30001 | LBB 8003/00 | Needed to guard 2 contacts |
| 1 | Image Basic Software Package | 8900 800 00101 | LBB 8000/01 | Installed at the server PC |
| 1 | Activation Logging | 8900 860 00001 | LBB 8600/00 | To activate registration of calls/handling |
| 1 | Activation Personal Security | 8900 860 10001 | LBB 8601/00 | To activate Personal security functions |
| 1 | Activation Multi Users | 8900 860 20001 | LBB 8602/00 | 3 extra simultaneous users |

- Notes:**
- Other relevant licences needed for a Basic Personal Security Server are already included
 - Refer to "Available Items" for relevant Gross Prices. (BLP), if the Basic Personal Security Server needs extra additions.

1.4 Extended Communication server

The 'Extended Communication Server' is offered as a complete set against a fixed Nett Price.

The content is defined such that the Extended Communication Server, next to the functions described in the Basic Message Server and Basic Personal Security Server, also covers an RS458 connection for max. 31 MPC contact couplers, Multi-site to control multiple sub-sites with one central Server and the possibility to connect (and integrate with) 3rd party systems. In the data sheet a functional description of the Basic Communication Server can be found. Below all hardware, software and licences that are included in this product is listed.

| Amount | Description | 12NC | Type nr | Nett Price 2021 |
|--------|-------------------------------|----------------|-------------|-----------------|
| 1 | Extended Communication Server | 8900 800 03001 | LBB 8000/30 | € 8.831,00 |

Content Extended Communication Server:

| Amount | Description | 12NC | Type nr | Remark |
|--------|---------------------------------|----------------|-------------|---|
| 1 | Communication Server PC | 8900 800 00001 | LBB 8000/00 | 1 per system |
| 1 | DP6000-IP Interface | 8900 800 10001 | LBB 8001/00 | 1 per (sub) system |
| 1 | RS485 Interface Module | 8900 590 40001 | LBB 5904/00 | To work with LBB5843/01 |
| 1 | ESPA 4.4.4. Interface Module | 8900 590 30001 | LBB 5903/00 | Port 3 can be set as output port |
| 1 | Input Contact Module | 8900 590 10001 | LBB 5901/00 | 4 contacts at 1 module |
| 1 | Cable set (set of 2) | 8900 800 30001 | LBB 8003/00 | Needed to guard 2 contacts |
| 1 | Output Contact Module | 8900 590 20001 | LBB 5902/00 | Adds 2 extra output contacts |
| 1 | Image Basic Software Package | 8900 800 00101 | LBB 8000/01 | Installed at the server PC |
| 1 | Activation Logging | 8900 860 00001 | LBB 8600/00 | Needed to activate |
| 1 | Activation Personal Security | 8900 860 10001 | LBB 8601/00 | To activate Personal security functions |
| 1 | Activation Multi Users | 8900 860 20001 | LBB 8602/00 | To add 3 extra simultaneous users |
| 1 | Activation Multi Site | 8900 860 30001 | LBB 8603/00 | To control multiple DP6000-IP Interfaces |
| 1 | Activation 3rd Party Connection | 8900 860 80001 | LBB 8608/00 | If 3 rd parties want integration with e.g. BMS |

- Notes:**
- In case of Multisite operation for each extra (sub) site an extra DP6000-IP interface must be added to the system.
 - Other relevant licences needed for a Basic Personal Security Server are already included
 - Refer to "Available Items" for relevant Gross Prices. (BLP), if the Basic Communication Server needs extra additions



International Pager Services B.V.
Willem de Haasstraat 5
5421 TN Gemert
The Netherlands
<https://www.pagerservices.nl>

© 2021 International Pager Services B.V. - All rights reserved
Data subject to change without notice