

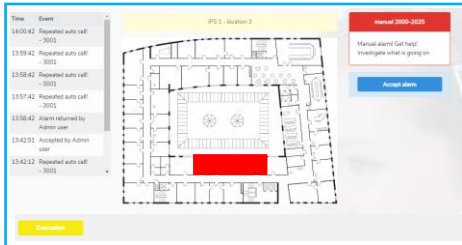

## Demonstration set Communication Server

*Demonstration Set\_DP\_Server\_EN\_21.28*



**Date:** 1<sup>st</sup> of July 2021  
**Product:** Communication Server  
**Product release date:** 1<sup>st</sup> of July 2021

### Product description

The Demonstration Set Communication Server consists of a professional PC with Linux based software and a DP6000-IP Interface to connect the server PC with the DP6000 system.

The Communication Server and DP6000-IP interface replaces the former Alpha-desk and Atus Commander. Several new functions, a graphical user interface and new application possibilities are implemented to meet the today's functional demands and high reliability standards.

Thanks to the newly designed system architecture it is easier to create system redundancy.

### Keywords:

- ▶ Linux based software
- ▶ Flexible system architecture
- ▶ Guarded system infrastructure
- ▶ Integral system redundancy
  
- ▶ Manned and unmanned work mode
- ▶ Designed to handle critical messaging and Personal Security applications
- ▶ Suitable for Dutch NEN2575 applications (evacuation system)
- ▶ Detailed logging and reporting facilities
- ▶ Different authorisations to log on to secure system performance.
  
- ▶ ESPA 4.4.4 coupling
- ▶ I/O contact coupling with voltage free input contacts
  
- ▶ Remote Maintenance through protected Web based access

Powered by:  
Next Generation  
Technology



## 1 Demonstration Set Communication Server

The overviews below shows all options of hardware, software and licences.

### Available Items

The 'Demonstration Set Communication Server is offered as a complete set, for a fixed Nett Price.

The Demonstration Set package covers all functions for critical messaging including out of range indication, absent detection, call forwarding, making group calls, low battery indication, fast buttons, Personal Security functions like System monitoring, Personal Security alarms from mobiles, location detection, guard-tour and logging of alarm handling.

Below all hardware, software and licences that are included in this product is listed.

Amount	Description	12NC	Type nr	Nett Price 2021
1	Demonstration Set Communication Server	8900 800 04001	LBB 8000/40	€ 2.980,00

### Content Extended Communication Server:

Amount	Description	12NC	Type nr	Remark
1	PC	8900 800 00002	LBB 8000/02	1 per system
1	DP6000-IP Interface	8900 800 10001	LBB 8001/00	1 per (sub) system
1	ESPA 4.4.4. Interface Module	8900 590 30001	LBB 5903/00	Port 3 can be set as output port
1	Input Contact Module	8900 590 10001	LBB 5901/00	4 contacts at 1 module
1	Cable set (set of 2)	8900 800 30001	LBB 8003/00	Needed for 2 internal contacts
1	Image Basic Software Package	8900 800 00101	LBB 8000/01	Installed at the server PC
1	Activation Logging	8900 860 00001	LBB 8600/00	Needed to activate
1	Activation Personal Security	8900 860 10001	LBB 8601/00	To activate Personal security functions
1	Activation Multi Users	8900 860 20001	LBB 8602/00	To add 3 extra simultaneous users
1	Activation Multi Site	8900 860 30001	LBB 8603/00	To control multiple DP6000-IP Interfaces
1	Activation 3rd Party Connection	8900 860 80001	LBB 8608/00	If 3 <sup>rd</sup> parties want integration with e.g. BMS

### Notes:

- Licence are active for 72 hours. After reboot licence will be active again for 72 hours.
- Demonstration Set is not intended for commercial purposes.



International Pager Services B.V.  
Willem de Haasstraat 5  
5421 TN Gemert  
The Netherlands  
<https://www.pagerservices.nl>